

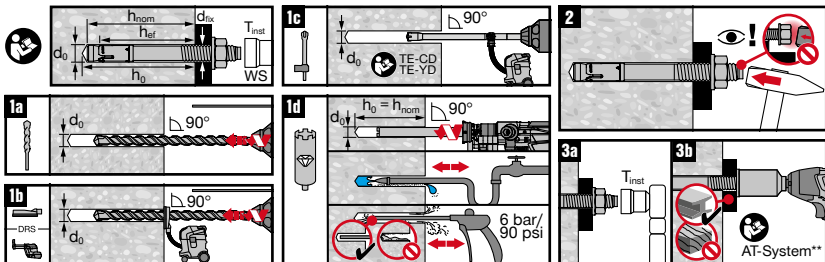

KB-TZ2 KB-TZ2 SS304 / SS316



2274242-03.2025



Symbol	Symbol Description	Units	Anchor Diameter [inch]													
			1/4	3/8	1/2	5/8	3/4	1	1 1/4	1 1/2	1 3/4	2				
	Hollow Drill Bit	-	-	-	✓	✓	✓	✓	✓	✓	✓	✓	✓	✓	✓	
	Dust Removal Systems	-	✓	✓	✓	✓	✓	✓	✓	✓	✓	✓	✓	✓	✓	
AT-System	SIW 6AT-A22 + SI AT-A22	-	-	✓	✓	✓	✓	✓	✓	✓	✓	✓	✓	✓	✓	
	SIW 4AT-22 + SI-AT-22	-	-	✓	✓	✓	✓	✓	✓	✓	✓	✓	✓	✓	✓	
	SIW 6AT-22 + SI-AT-22	-	-	✓	✓	✓	✓	✓	✓	✓	✓	✓	✓	✓	✓	
	Diamond Core Bit	-	-	-	✓	✓	✓	✓	✓	✓	✓	✓	✓	✓	✓	
d_0	Drill Bit Diameter	[inch]	1/4	3/8	1/2	5/8	3/4	1	1 1/4	1 1/2	1 3/4	2	2 1/4	2 1/2	2 3/4	
h_{ef}	Effective Embedment Depth	[inch]	1 1/2	1 1/2	2	2 1/2	2	2 1/2	3 1/4	2 3/4	3 1/4	4	3 3/4	3 3/4	4 3/4	4 5/8
h_{nom}	Nominal Embedment Depth	[inch]	1 3/4	1 7/8	2 1/2	3	2 1/2	3	3 3/4	3 3/4	4 1/2	4	4 1/2	5 1/2	4 3/4	6 3/8
h_0	Minimum Hole Depth in Base Material	[inch]	2	2	2 3/4	3 1/4	2 3/4	3 1/4	4 1/4	3 3/4	4 1/4	4 1/4	4 1/4	4 3/4	5 3/4	6 3/4
$T_{inst, concrete}$	Installation Torque Concrete	carbon steel	(ft-lb)	4	30	50	40	40	110	185						
		SS304, SS316	(ft-lb)	6	30	40	60	125	185							
$T_{inst, grout filled CMU}$	Installation Torque Grout-Filled CMU	carbon steel	(ft-lb)	4	15	25	30	50	-							
		SS304, SS316	(ft-lb)	6	15	25	35	50	-							
d_{fix}	Fixture Hole Diameter	[inch]	5/16	7/16	9/16	1 1/16	1 3/16	1 1/2								
WS	Wrench Size	[inch]	7/8	9/8	3/4	1 5/16	1 1/2									

Use only carbide-tipped masonry drill bits complying with ANSI B212.15.1994

For steps 1a or 1b, make sure to drill deep enough to achieve h_0 , taking into account the depth of debris remaining in the hole.

** AT-System not applicable for grout-filled CMU and wood fastening applications.

For UL Listing, the 3/4" anchor is rated up to 10 NPS at a minimum of 3-1/4" nominal embedment. UL Listing does not cover the 1/4" and 1" anchor sizes.